

# THE HARD FACTS MADE EASY

## Everything you need to know about your Wyndham Garden Manama



### + LOCATION

Wyndham Garden Manama is located in Juffair, 10 minute drive from Bahrain International Airport and near to shopping centres and Al Fateh Grand mosque.

With the largest number of rooms in Bahrain, the hotel offers 441 elegant rooms and 1, 2 & 3 bedroom apartments with various dining options, banquet and meeting room areas and dedicated leisure and relaxation facilities.

### + FEATURES

- 24 Hours room service
- Free Wi Fi
- Laundry and dry-cleaning services
- Executive floor with lounge
- Exclusive alcohol free floors
- Inter-connecting rooms
- Walk in shower or jacuzzi bath
- Outdoor temperature controlled swimming pool / children's pool
- Gymnasium, jacuzzi and steam room for gents and ladies
- Spa
- Beauty centre and salon
- Flower and gift shop / travel desk
- Accessible rooms

### + ROOM DETAILS

- Most suites feature kitchenette and additional single bed or study room
- Flat screen interactive TV with satellite channels
- Complimentary coffee & tea making facilities
- Safe deposit box
- Hair dryer
- Iron and board

### + MEETING SPACE HIGHLIGHTS

- Business centre
- Meeting rooms are equipped with state-of-art facilities including LCD projector screen, DVD/CD player, sound system, Wi-Fi, cordless microphone, flipcharts with assorted markers and whiteboards

SET UP STYLE	CAPACITY
Theatre	100 Guests
Conference	60 Guests
Multi Purpose	100 Guests

# THE HARD FACTS MADE EASY

## Everything you need to know about your Wyndham Garden Manama



JASHAN

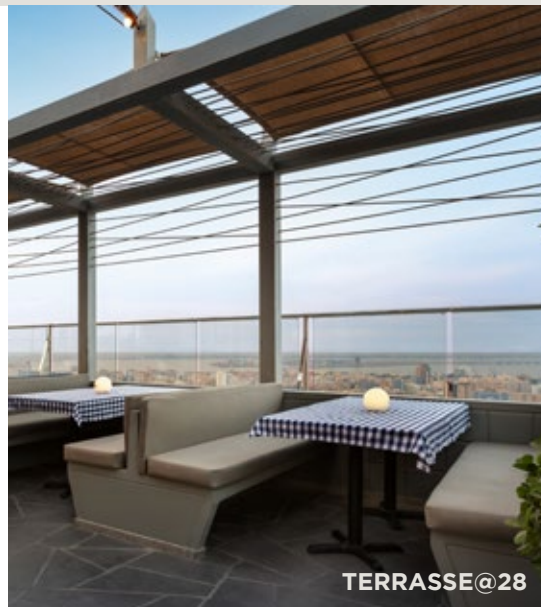

TERRASSE@28



VIA BRASIL

### + DINING AND ENTERTAINMENT

Wyndham Garden Manama features world-class speciality dining and entertainment options, that's sure to deliver the finest experience in the very heart of the city.

- Jashan - Savour the authentic taste of Indian cuisine with a wide variety of traditional Indian recipes reflecting the diversity of India.
- Café Mosaic - This international all day dining outlet is perfect for a business lunch or relaxed dining with friends and family. The restaurant offers a wide selection of delightful dishes prepared at live cooking stations.
- Trattoria - For a unique Italian experience, Trattoria will take you through a culinary trip of Italy.
- Via Brasil - Take a journey through our festive fare of Brazil, with live entertainment.
- Player's Lounge - watch your favourite sports channels with friends and colleagues.
- Terrasse @ 28 - The open air roof top is dedicated to serving the best Belgian and German food and drink, in a relaxed friendly environment.
- Deli shop – Grab a quick bite from the Deli Shop

### + ATTRACTIONS

- Al Fateh Grand Mosque
- Bahrain City Centre
- Bab Al Bahrain - Manama Souq
- Bahrain Fort / Arad Fort
- Bahrain International Circuit
- Bait Al Quran
- The Lost Paradise Water Park
- Al Areen Wildlife
- Tree of Life
- King Fahad Causeway
- National Museum
- Dragon City (China Market)

### + GETTING THERE

Directions from Bahrain International Airport

Distance: 10 Minutes

Directions: Exit from Airport at the first roundabout, take road No. 2403 to Arad highway and drive towards Khalifa Al Kabeer highway going towards Muharraq. Take Shaikh Hamad Causeway that goes towards Manama. Enter left at Al Fateh highway and drive for 3 kms. Enter left again into Awal Avenue. At Al Fateh Grand Mosque signal, take the first right toward Shabab Avenue, then take right again at the end of Shabab Avenue; followed by the second left on Road 4005. On Road 4005, take the second right towards Road 4003 to reach the hotel.

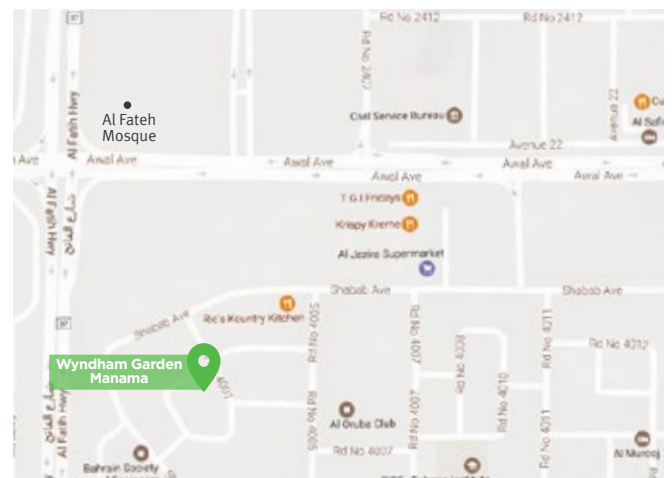

Building 65, Road 4003, Block 340, Juffair | P.O. Box 13220 | Manama, Kingdom of Bahrain

Tel: +973 6631 6666 | Fax: +973 6631 6667

Email: [info@wyndhamgardenmanama.com](mailto:info@wyndhamgardenmanama.com) | Website: [wyndhamgardenmanama.com](http://wyndhamgardenmanama.com)